

4V 400

系列电磁阀, 气控阀 Series Solenoid valve, air control valve

100-400

100-400 系列底座 series sub-base



底座订购码 Order Code

100M - □F

系列代号/Series Code
 100M: 100系列用底座 Base for 100 Series Use
 200M: 200系列用底座 Base for 200 Series Use
 300M: 300系列用底座 Base for 300 Series Use
 400M: 400系列用底座 Base for 400 Series Use

连座数目/Joint Base Number
 100M: 任意连 No limited
 200M: 任意连 No limited
 300M: 任意连 No limited
 400M: 任意连 No limited

盲板订购码 Block Plate Order Code

100M - B

系列代号/Series Code
 100M: 100系列用底座 Base for 100 Series Use
 200M: 200系列用底座 Base for 200 Series Use
 300M: 300系列用底座 Base for 300 Series Use
 400M: 400系列用底座 Base for 400 Series Use

盲板代号/Block Plate Code
 B: 底座用盲板
 Block Plate

当底座数目超过电磁阀使用数目时, 可先用盲板将多余孔暂时密封。
 Please use block plate to block the base when base QTY is more than Valve QTY.

外形尺寸 Outlook & Dimension

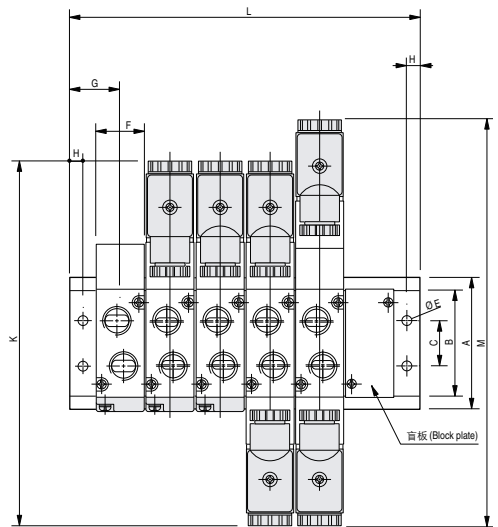
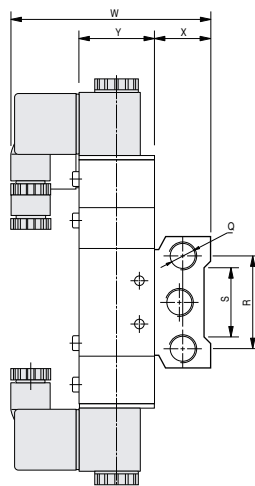

底座尺寸 Base Size Sheet

内径/符号 Inside Diameter / Symbol	A	B	C	E	F	G	H	K	L	M	Q	R	S	W	X	Y
100M-□F	58	44	20	4.2	18.3	19	5	140	(n-1)x19+38	155	G1/4	40	30	78.5	25	27
200M-□F	61	51	21	4.3	22.4	23	6	170	(n-1)x23+46	189	G1/4	43	32	92.5	26	35
300M-□F	75	65	26	4.5	27.3	27	6	189	(n-1)x28+54	208	G3/8	53	48	99	30	40
400M-□F	104	95	32	5.5	34.3	31.5	7	222	(n-1)x35+63	243	G1/2	68	67	112	38	50